



E SERIES

AUTOMATIC CARPET WASHING MACHINE

SPECIFICATIONS

- Single brushing unit (with 4 or 5 brushes depending on the size)
- High pressure rinsing unit
- Moving scrapper unit
- Rolling unit
- Hot-dipped galvanized chassis with stainless steel covers
- Ability to wash all types of carpets
- Speed control operating system
- Fragmental conveyor belt system that prevents belt stoll
- Button control system that provides detergent, electricity and water conservation
- Automatic detergent and water pump system
- Pneumatic brush pressure system





E SERIES

AUTOMATIC CARPET WASHING MACHINE

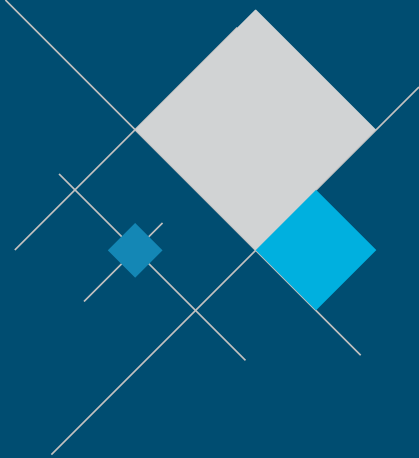

E SERIES AUTOMATIC CARPET WASHING MACHINE

- 1 SINGLE BRUSHING UNIT
- 2 HIGH PRESSURE RINSING UNIT
- 3 MOVING SCRAPER UNIT
- 4 CYLINDRICAL DOWN ROLL BRUSH
- 5 ROLLING SYSTEM

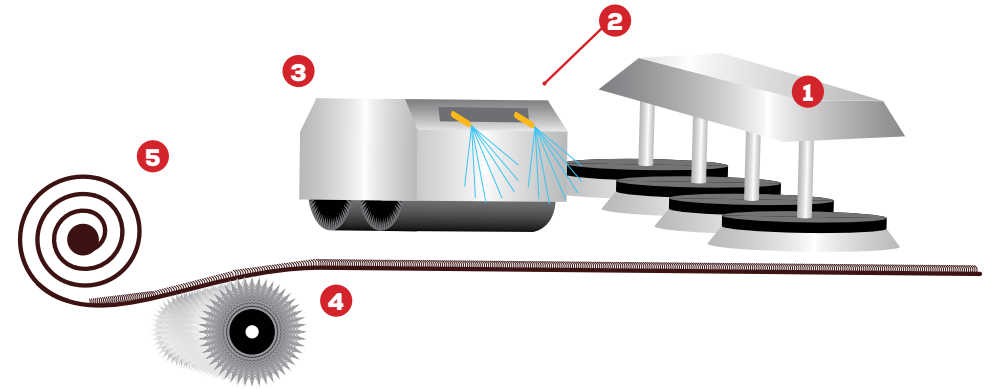



E SERIES

AUTOMATIC CARPET WASHING MACHINE

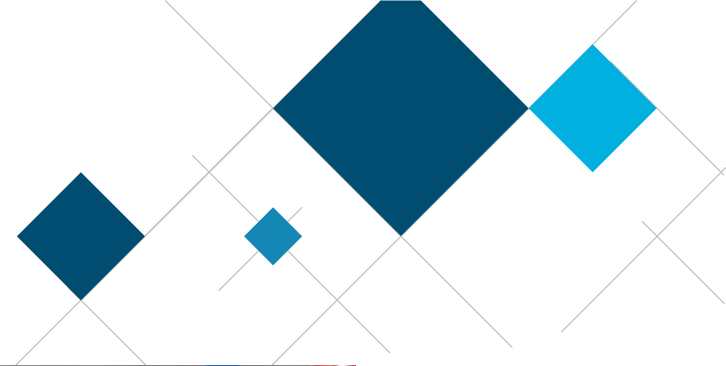

SPECIFICATIONS	HYM 284-E	HYM 335-E	HYM 435-E
Max. Carpet Width	260 cm	320 cm	420 cm
Dimensions	330x225x170 cm	390x225x170 cm	490x225x170 cm
Weight	1600 kg	2200 kg	2700 kg
Washing Capacity	150 m ² /h	180 m ² /h	240 m ² /h
Number of Brushes	4 disc + moving scrapper + down roll brush	5 disc + moving scrapper + down roll brush	5 disc + moving scrapper + down roll brush
Engine Power	9 kW	10 kW	10 kW
Electricity	3 phase / 380 V / 50 Hz		
Button Control		✓	
Speed Control		✓	
Electronic Sensor System		✓	
Detergent Tank		✓	
Automatic Detergent Pump System		✓	
Carpet Trolley		✓	
Rolling System		✓	

WATCH MACHINE VIDEO

